

# FPS

## Submersible Turbine Pumps



Franklin Electric

# Submersible Turbine Pumps

## ST Series

### Performance Data:

Discharge Size: 4" and 6" FNPT  
 Capacity: 100 to 700 gpm @ "B.E.P"  
 HP: 5 hp to 125 hp  
 Head: Up to 2250 ft

### Applications:

- Irrigation
- Farm Use
- Industry
- Municipal
- Commercial

### Features:

- 100% Franklin factory wet tested at 3 points on curve
- Ductile iron discharge and suction bracket
- Ductile iron bowls bolt together for easy service
- Stainless steel upthrust bolt provides exceptional upthrust protection
- Bronze discharge bearing is grease packed for maximum bearing protection
- Fluted rubber bearings in all bowls
- Suction inlet located above bottom bearing prevents abrasives from entering the bearing
- Suction bracket design allows easy access to coupling
- Bronze bracket bearing is protected with stainless steel sand collar
- Stainless steel impellers with stainless steel taper lock secures impeller to shaft
- Stainless steel pump shaft for increased durability
- Shaft coupling is keyed to pump by set screws and is splined to fit motor shaft
- 4" discharge tapping FNPT for 6" turbines
- 4" and 6" discharge tapping FNPT for 8" turbines



Item	Standard Construction	ASTM Reference	Feature
Suction Bracket	Ductile Iron	A536 65-45-12	6" or 8" motor fit
Suction Bearing	Bronze	B505 C954	Improved shaft stability
Top Bowl	Ductile Iron	A536 65-45-12	Bolted
Inter Bowl	Ductile Iron	A536 65-45-12	Bolted
Bowl Bearing	Nitrile ALT - Bronze		Fluted design for abrasion resistance
Impeller	304SS	A743 CF-8	Efficient design
Taper Lock Collet	Stainless Steel	A276	Secures locking of impeller
Sand Collar	Stainless Steel	A276	Shields bearing from abrasives
Shaft	416 SS	A582 416	Corrosion resistant, long life
Discharge Bracket	Ductile Iron	A536 65-45-12	4" or 6" NPT tapping
Discharge Bearing	Bronze	B505 C954	Grease packed
Upthrust Bolt	Stainless Steel	A320 304	Proven longevity
Suction Screen	Stainless Steel	A666	Non-collapsible, Corrosion resistant
Bolting	Stainless Steel	A320 304	Easy maintenance
Shaft Coupling	Stainless Steel	A276	Keyed to pump by set screws splined to motor shaft
Cable Guard	Stainless Steel	A666	Corrosion resistance, long life

**Notes:** Quick Ship 6" Submersible Program available on selected models.

## ST Series

### 6" Turbine Family Curve

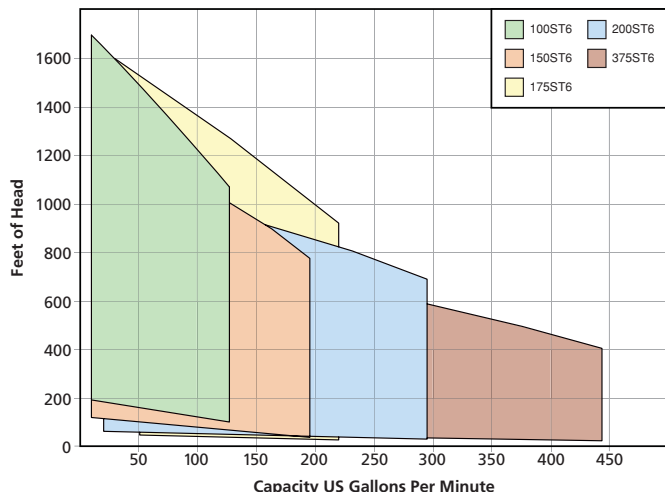

### 8" Turbine Family Curve

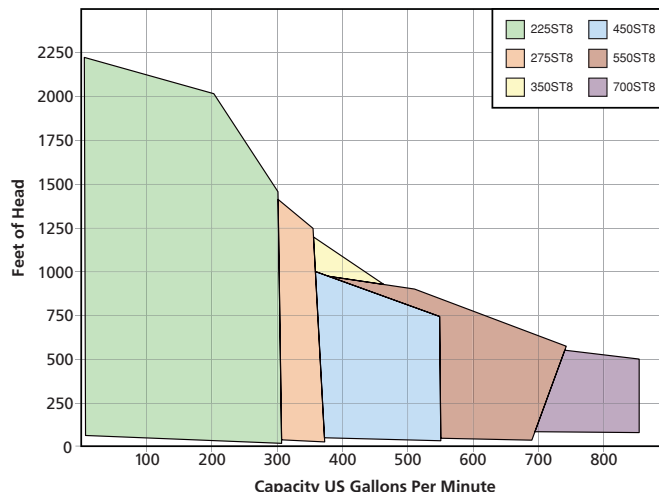

#### Upthrust Bolt

Protects pump during momentary upthrust at start-up (factory set).

#### Discharge Bracket

Heavy duty casting with threaded NPT connection, supports grease packed extra long discharge bearing.

#### Bolting, Fasteners, Cable Guard

Stainless steel for strength and corrosion resistance.

#### Intermediate Bowl

Heavy duty casting, flanged, supports inter bowl bearing in standard rubber material for reliable long life. 8" bowl coated for increased efficiency.

#### Impeller

Enclosed design to optimize efficiency, precision machined taper-lock is designed to ensure locking of impeller to shaft, impeller is single plane dynamic balanced as standard.

#### Pump Shaft

Minimum 100,000 psi tensile for maximum strength and corrosion resistance, ground and polished for a smooth bearing surface.

#### Suction Bracket

Heavy duty casting precision machined to ensure positive motor alignment, contoured for smooth flow entrance, supports standard stainless steel sand collar.

#### Suction Screen

Stainless steel design is non collapsible and corrosion resistant.

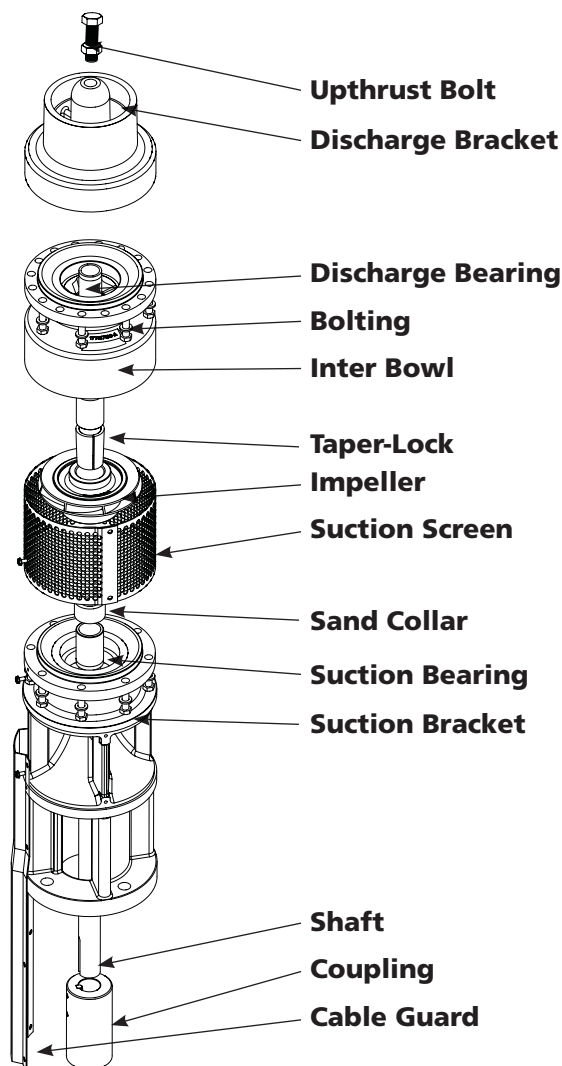



**Franklin Electric**

400 East Spring Street, Bluffton, Indiana 46714  
Tel: 260.824.2900 Fax: 260.824.2909

[www.franklin-electric.com](http://www.franklin-electric.com)